

MEASUREMENT REPORT

GRAFTON EDM TESTLINE

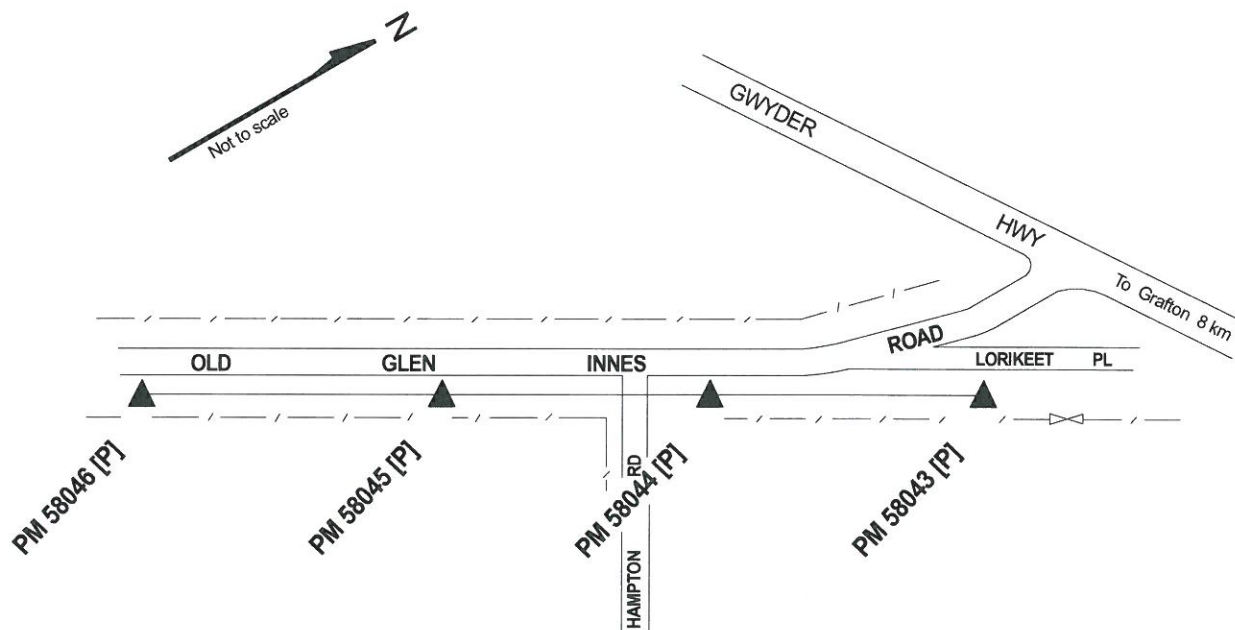

ACCESS : Unrestricted (3/8" Allen key required to remove pillar caps)

HORIZONTAL DISTANCES (metres) AT DATUM 67.536 m AHD

From	To	Distance	Mark	RL (AHD) *
PM 58043	PM 58044	185.996	PM 58043	72.040
PM 58043	PM 58045	388.240	PM 58044	67.571
PM 58043	PM 58046	609.949	PM 58045	67.536
			PM 58046	70.305

* The Reduced Levels (in metres AHD) were not re-verified at this date.

Method of verification: VA-QM-01 and NMI's Verifying Authorities Handbook, 2nd Ed. November 1988

Distances by the Surveyor-General of NSW, in accordance with the verification of a Reference standard of length as prescribed by the National Measurement Act 1960.

Instrument used : Leica TS 30, Serial No. 360783

Verified in accordance with Regulation 13 of the National Measurement Regulations 1999.

Uncertainty of distances: +/- (0.5mm + 1.3ppm)

This uncertainty is calculated in accordance with the principles of the ISO Guide to the Expression of Uncertainty in Measurement, with an interval estimated to have a confidence level of 95% and a coverage factor of 2. The uncertainty applies at the time of measurement only and takes no account of pillar movement that may occur after the date of verification.

Accredited for compliance with ISO/IEC 17025.

The results of the tests, calibrations and/or measurements included in this document are traceable to Australian national standards.

This document shall not be reproduced, except in full.

NATA Accredited Laboratory Number: 14965



R. K. Lock date 18/11/13

Senior Surveyor
Legal Metrology Officer
for the Surveyor-General of NSW

Date of Verification: 23 July 2013